



IPA MICRO-CLEAN 35 WIPE

High-PH Cleaner and Isopropanol (IPA) Alcohol A Fast-Acting Wipe

PRODUCT DESCRIPTION

A large, durable, pre-moistened, non-abrasive wipe infused with a specially formulated high pH cleaning solution and 35% Isopropanol (IPA) alcohol.

The pre-moistened wipe system is packaged in a convenient plastic pail with a pull up dispenser.

FIELDS OF APPLICATION

- Transit Centers
- Airports, Seaports
- Vehicles, Buses, Trains, Aircraft and Vessels
- Schools
- Corporate Campuses
- Manufacturing Facilities
- Community Infrastructure
- Event Centers
- Elevators
- Public Spaces (Shopping Mall, Theatre)
- Other populated locations
- Jobsites
- Equipment

PRODUCT FEATURES

Removes grease, oils, dirt, dust, sticky foods, residues and other contaminants.

PACKAGING

90, 12"x12", polypropylene wipes in a plastic pail



TECHNICAL DATA

Properties @ 77°F (25°C)

Relative Density (S.G.)	0.87 – 0.92
Freeze Temperature, °F (°C)	-10 (-23.3)
Boiling Point, °F (°C)	172.0 (77.7)
For cleaning	Water
Color	Clear
Odor	Alcohol + Fragrance
pH	<11
Toxicity	Yes, if consumed
Flashpoint, °F (°C), ASTM D93-11	95 (35)
Fumes During Application	Light Alcohol
Environmental Hazards	None
Thinners Required	None
Drying Time	1 – 2 minutes

APPLICATION

Dispensing Directions: Remove white ring-seal on side of lid. Open pail lid and blue cap. From the center of the roll, pull up a wipe corner, twist into a point and thread through the hole in the blue cap located in the center of the lid. Pull through about one (1) inch. DO NOT PUSH FINGER THRU BLUE OPENING. Replace lid. Pull the first wipe up and tear off at an angle. The remaining wipes feed automatically. When not in use, keep lid and blue cap securely closed to prevent evaporation.

Preparation: Heavily soiled surfaces may require repeated wiping. On hard, non-porous surfaces and articles, use a fresh wipe to thoroughly clean the surface

Method of Application: Wipe the surface with a clean face of the wipe by folding as illustrated below.

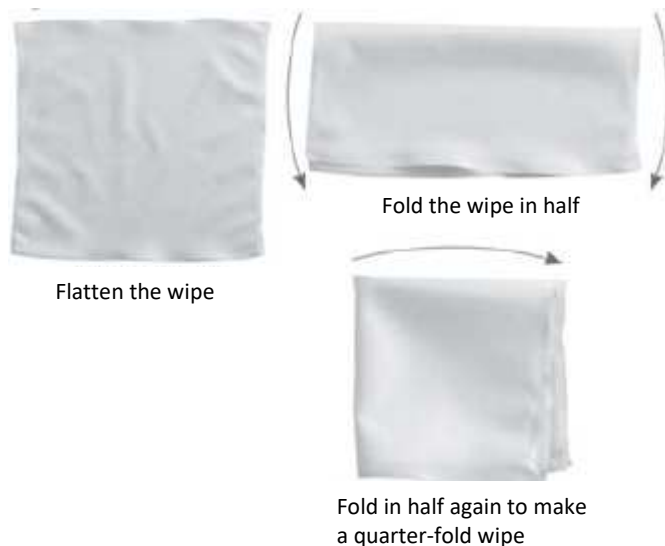

Gloves and eye protection recommended.

By folding the wipe, several clean surface areas are produced. Use a new pre-moistened wipe at each new location. Wipe in one direction, overlapping wiped areas.

Wipe from cleanest to least clean regions of the surface. Wipe systematically, for example, from top to bottom or far to near.

Keep track of which surfaces have been cleaned. Always use the cleanest surface of the wipe. If re-wiping, use a clean portion of the wipe. Dispose of wipe according to site procedures.

Coverage: Coverage depends on type of surface, e.g., countertops, desktops, railings, doorknobs, actuator buttons, etc. or equipment complexity, printer, mouse, kitchen appliances, etc. Do not use the same wipe on multiple surfaces. This can spread germs and dirt from one space to another.

Limitations: Do not apply in the following cases:

- Do not wipe hot surfaces or approach open flame
- Do not apply to porous surfaces
- Do not apply to fine wood surfaces
- May damage shellac mounting of lensed instruments, may swell and harden rubber and certain plastic tubing after prolonged and repeated use
- Not intended to sterilize medical devices or apparatus
- Do not dilute or combine with other products
- Do not dispose of wipe in toilet
- Do not use wipe if it has become dry
- Not for consumption
- Not intended for personal hygiene

STORAGE

One-year shelf life when stored in cool, dry, well ventilated place in unopened container. Do not allow product to freeze.

SAFETY PRECAUTIONS

As with all chemical products, adequate precautions and care must be taken during use and storage. Avoid direct contact with foodstuff, eyes and mouth. If contact with eyes or mouth should occur, rinse thoroughly with clean water. Do not contact with open cuts or wounds. Immune compromised or highly sensitive individuals should not use this product.

Certain medications may increase the effects of IPA on sensitive users, even in small amounts. Should headache, dizziness or discomfort occur, discontinue use and move to fresh air. Seek medical assistance if symptoms persist.

TECHNICAL ASSISTANCE

Please contact International Chem-Crete Corporation for Technical Personnel.

WARRANTY

LIMITED WARRANTY: International Chem-Crete Inc. warrants that, at the time and place we make shipment, our materials will be of good quality and will conform to our published specifications in force on the date of acceptance of the order.

DISCLAIMER: The information contained herein is included for illustrative purposes only and to the best of our knowledge, is accurate and reliable. International Chem-Crete Inc. is not under any circumstances liable to connection with the use of information. As International Chem-Crete Inc. has no control over the use to which others may put its products, it is recommended that the products be tested to determine the suitability for specific applications and/or our information is valid in particular circumstances.

Rev. December 11, 2020



Manufactured by:

International Chem-Crete Inc.,
800 Security Row, Richardson, TX 75081, U.S.A
Tel: (972) 671-6477, Fax: (972) 238-0307
contactus@chem-crete.com • www.chem-crete.com

Chem-Crete Europe, s.r.o.
Stanicna 13, 90851, Holic, Slovakia
Phone: +421 34 66 83 181, Fax +421 34 66 83 119